

# ELEVAH E6 ES MOVE

Max. working height	6 m	
Max capacity	120 kg	
Number of people	1	
Use	Internal	
<b>A</b>	Closed machine height	1996 mm
<b>B</b>	Minimum platform height	289 mm
<b>C</b>	Maximum platform height	3980 mm
<b>D</b>	Base overall dimensions	1105 mm
<b>E</b>		780 mm
<b>G</b>	Cage dimensions	1240 mm
<b>F</b>		690 mm
Machine weight	1000 kg	
Drive wheels dimension	Ø 186 x 60 mm	
Swivel wheels dimensions	Ø 150 x 40 mm	
Adjustment/extraction	Manual	
<b>J</b>	Stroke	850 mm
Minimum extension	1240 mm	
Maximum extension	2090 mm	
Power supply	24 V	
Batteries	2 Trojan Lead-Acid 12V 105 Ah	
Battery charger	115V – 230V 50/60HZ	
<b>M</b>	Maximum climbing ability	15%
Climbing ability at height	2,5%	
Internal turning radius	0	
External turning radius	1350 mm	
Max. speed (rising – descending)	0,2 m/s	
Maximum shifting speed	5,5 km/h	
Maximum shifting speed at height	1 km/h	
<b>N</b>	Maximum pressure for wheel at full load**	3,8 kN
Work cycles (with fresh batteries) ***	100	

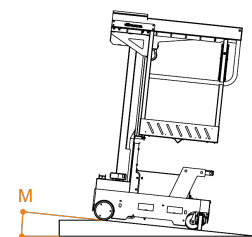
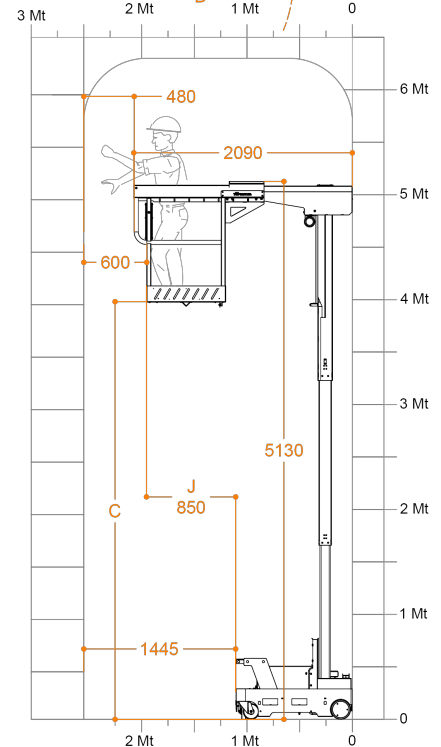
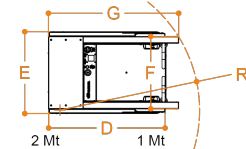
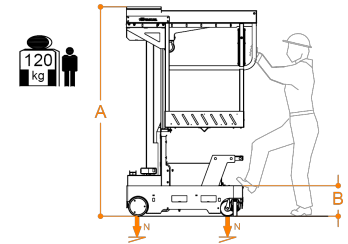

\* There is an intermediate step.

\*\* Maximum pressure whereas the weight of the platform plus the maximum load on the basket are completely distributed on one side of the platform (totally asymmetric load).

\*\*\* By work cycle we mean a self-propelled movement of 20 m with a full ascent to and descent from the maximum height and with adjustment of the loading platform.



Compliant with **EN280** rule.  
Approved for indoor use or outdoor use in the absence of wind.